

# Sockets - Taper-Lok™

## Taper-Lok™ Impact Sockets

These sockets are used on the PSI Twin Hammer and Pin Clutch tools. STANLEY Assembly Technologies' Taper-Lok™ ergonomic sockets will greatly improve productivity by increasing torque accuracy, operator comfort, and reduce torque loss.

A taper inside the drive end of Taper-Lok™ sockets creates a fit that is perfectly snug with the tapered output of the impact tool anvil. This controlled alignment eliminates the vibration and rattle normally created by the loose fit and wobble of standard impact tool sockets. No vibration or wobble means a higher capability as more torque is delivered consistently to the fastener with reduced operator fatigue and injury.

3/8" DRIVE

## Taper-Lok™ 3/8" Drive, Fast-Lead, 6-point, Hex

Metric Size (mm)	Length		Diameter		Part Number	Dowel Pin	External O-Ring
	mm	in	mm	in			
8	41.402	1.63	18.796	0.74	24W500454	24R501280	24R501270
10	41.402	1.63			24W500455		
12	41.402	1.63			24W500456		
13	44.958	1.77			24W500457		
14	44.958	1.77			24W500458		
15	50.546	1.99			24W500459		
16	50.546	1.99			24W500460		
17	50.546	1.99			24W500461		
18	58.42	2.3			24W500462		
19	58.42	2.3			24W500463		

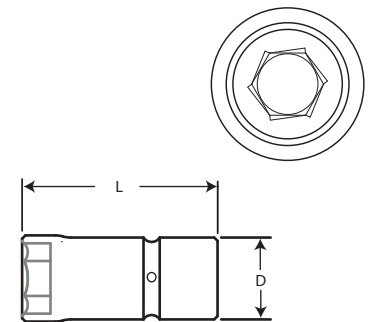

3/8" Impact Socket Set	Part No.
3/8" Drive, Taper-Lok™, Metric, Impact Socket-Set Contains 1-each of the sockets listed on the left	24W500453

SAE Standard Size (in)	Length		Diameter		Part Number	Dowel Pin	External O-Ring
	mm	in	mm	in			
1/4	41.402	1.63	18.796	0.74	24W500476	24R501280	24R501270
5/16	41.402	1.63			24W500477		
11/32	41.402	1.63			24W500478		
3/8	44.958	1.77			24W500479		
7/16	44.958	1.77			24W500480		
1/2	50.546	1.99			24W500481		
9/16	50.546	1.99			24W500482		
5/8	50.546	1.99			24W500483		
11/16	50.546	1.99			24W500484		
3/4	58.42	2.3			24W500485		
13/16	58.42	2.3			24W500486		
7/8	58.42	2.3			24W500487		

3/8" Impact Socket Set	Part No.
3/8" Drive, Taper-Lok™, SAE, Impact Socket-Set Contains 1-each of the sockets listed on the left	24W500475