

## For Sanding and Polishing

## Angle Sanders

- LSV12 series** – For finer work where less power and more control are needed. Available with collet or threaded spindle.
 

Features: Speed governor, high quality gears and lever with feathering characteristics.
- LSV19 series** – For work in cramped spaces. Available with collet or threaded spindle versions.
 

Features: Speed governor, sealed angle head and lubrication-free air motor.
- LSV28 series** – The 28 series comes in various speeds.
 

Features: Speed governor, sealed angle head, LF models have lubrication-free air motor.
- LSV38 series** – Powerful one hand sander for medium rough to rough sanding.
 

Features: Speed governor, sealed angle head, lubrication-free air motor and spindle lock.
- LSV48 series** – Our most powerful angle vane sander with 2.5 hp for ultimate productivity.
 

Features: Speed governor, sealed angle head, lubrication-free air motor, autobalancer and spindle lock.



Model	Max free speed r/min	Rec. pad size dia in	Max output hp	Weight lb	Length in	Height in	Air consumption		Spindle thread and length in	Rec. hose size in	Air inlet thread NPT	Ordering No.
							at max output cfm	at free speed cfm				
<b>With collet</b>												
LSV12 S200-2	20000	2	0.39	1.2	6.5	3.0	17.6	6.4	– <sup>a</sup>	5/16	1/4	8423 0701 06
LSV12 S120-2	12000	3	0.33	1.2	6.5	3.0	17.6	6.4	– <sup>a</sup>	5/16	1/4	8423 0701 05
LSV19 S200-2	20000	2	0.6	1.3	7.3	3.0	23	15	– <sup>a</sup>	3/8	1/4	8423 0703 75
LSV19 S120-2	12000	3	0.6	1.3	7.3	3.0	23	15	– <sup>a</sup>	3/8	1/4	8423 0703 76
LSV19 S080-2	8000	3	0.5	1.3	7.3	3.0	23	13	– <sup>a</sup>	3/8	1/4	8423 0703 77
<b>With threaded spindle</b>												
LSV12 S200	20000	2	0.39	1.2	6.5	2.3	17.6	6.4	UNC 1/4x5/16	5/16	1/4	8423 0701 08
LSV12 S120	12000	3	0.33	1.2	6.5	2.3	17.6	6.4	UNC 1/4x5/16	5/16	1/4	8423 0701 07
LSV19 S120	12000	3	0.6	1.3	7.3	2.3	23	15	UNC 1/4x8	3/8	1/4	8423 0703 78
<b>Dry sanding</b>												
LSV28 S085	8500	7	1.0	3.2	10.4	3.4	46	29	UNC 5/8x32	3/8	3/8	8423 0706 12
LSV28 S060 LF	6000	7	1.0	3.2	10.4	3.4	34	16	UNC 5/8x32	3/8	3/8	8423 0706 11
LSV28 S040 LF	4000	7	0.8	3.2	10.4	3.4	32	9	UNC 5/8x32	3/8	3/8	8423 0706 13
LSV28 ST034	3400	7	1.0	3.7	12.0	3.4	38	16	UNC 5/8x32	3/8	3/8	8423 0706 15
LSV28 S021 LF	2100	7	0.9	4.1	11.2	3.4	34	12	UNC 5/8x32	3/8	3/8	8423 0706 14
LSV38 S085	8500	7	1.7	3.5	8.5	3.8	58	31	UNC 5/8x23	1/2	3/8	8423 0700 24
LSV38 S066	6600	7	1.6	3.5	8.5	3.8	50	27	UNC 5/8x23	1/2	3/8	8423 0700 25
LSV38 S066 D	6600	7	1.6	3.5	8.5	3.8	50	27	UNC 5/8x28	1/2	3/8	8423 0700 26
LSV48 SA066	6600	7	2.5	5.1	11.8	3.5	76	36	UNC 5/8x21	5/8	1/2	8423 0707 50
LSV48 SA085	8500	7	2.5	5.1	11.8	3.5	76	36	UNC 5/8x21	5/8	1/2	8423 0707 51

Backing pads sold separately.

<sup>a</sup> Ø 1/4" collet.

- D = Spot suction kit included.

# Accessories

# For Sanding and Polishing

## Accessories Included

Air hose nipple  
Clamp  
Exhaust hose (LSV19/28/38)      Support handle (LSV28/38/48)  
Wrenches (LSV19/28)  
Spot suction equipment (D-version)

## Optional Accessories

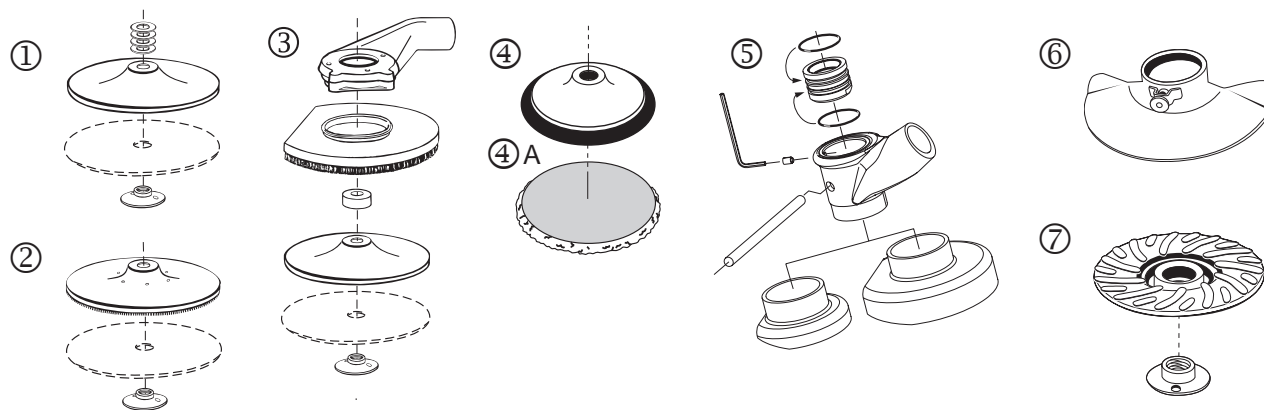

	LSV12	LSV19	LSV28	LSV38	LSV48	See illustration
<b>Backing pad set, standard type</b>						
Ø 5 in - 5/8" - soft	-	-	4170 0768 80	4170 0768 80	4170 0768 80	1
Ø 7 in - 5/8" - soft	-	-	4170 0756 80	4170 0756 80	4170 0756 80	1
Ø 7 in - 5/8" - stiff	-	-	4170 0757 80	4170 0757 80	4170 0757 80	1
<b>Backing pad set with cooling ribs</b>						
Ø 5 in - 5/8" and M14	-	-	4150 1962 80	4150 1962 80	4150 1962 80	2
Ø 7 in - 5/8" and M14	-	-	4150 1962 81	4150 1962 81	4150 1962 81	2
<b>Backing pad set, heavy duty type</b>						
Ø 120 mm - 5/8"	-	-	-	4170 1204 90	4170 1204 90	7
Ø 162 mm - 5/8"	-	-	-	4170 1192 90	4170 1192 90	7
<b>Backing pad set for polishing - velcro</b>						
Ø 150 mm - 5/8" (max 2500 rpm)	-	-	4112 6092 15	-	-	4
Ø 150 mm - Lambs woll bonnet	-	-	4112 6093 15	-	-	4A
<b>Spot suction kit for fiber disc</b>						
Ø 5 in	-	-	3780 4007 80 <sup>a</sup>	-	-	3
Ø 7 in	-	-	3780 4007 90 <sup>b</sup>	-	3780 4093 40	
			3780 4031 60 <sup>c</sup>			
Ø 2 - 3 in	3780 4092 64 <sup>d</sup>	3780 4092 62 <sup>d</sup> 3780 4092 65 <sup>e</sup>	-	-	-	5
Hand shield for 5-7 in	-	-	-	4150 1936 80	-	6
Hand shield for 5-7 in, large shield	-	-	-	4150 1941 80	-	6

<sup>a</sup> = Suits LSV28 S060<sup>b</sup> = Suits LSV28 S040/060<sup>c</sup> = Suits LSV28 S021<sup>d</sup> = For model with collet<sup>e</sup> = For model with threaded spindle

## Productivity Kits

Model	Max air flow	Hose 16.4 ft	Coupling	Lubrication	Ordering No.
MIDI Optimizer F/RD EQ10US-T13	65 cfm	Turbo 13	ErgoQIC 10US	Yes	8202 0850 29
MIDI Optimizer F/R EQ10US-T13	65 cfm	Turbo 13	ErgoQIC 10US	No	8202 0850 30
MIDI Optimizer F/RD EQ15US-T16	85 cfm	Turbo 16	ErgoQIC 15US	Yes	8202 0850 31
MAXI F/R EQ15US-T20	140 cfm	Turbo 16	ErgoQIC 15US	No	8202 0850 32
MAXI F/RD EQ15US-T20	140 cfm	Turbo 16	ErgoQIC 15US	Yes	8202 0850 33

**NOTE:** Tool nipple is not included in the Productivity kit and needs to be order separately together with the tool.



## Service Kits

LSV19	4081 0488 90
LSV28	4081 0317 90
LSV38	4081 0309 90
LSV48	4081 0312 90