



# MH12

ASSEMBLY | DISPENSING | MACHINE TENDING  
MATERIAL HANDLING | PACKAGING

### KEY BENEFITS

Versatile design applicable to multitude of applications.

Contoured arm design to improve access and reduce peripheral interferences.

Hollow-arm design for ease of cable management and enhanced cable life.

### SPECIFICATIONS

12 kg payload

1,440 mm horizontal reach

2,511 mm vertical reach

±0.08 mm repeatability

### CONTROLLERS



DX200



FS100



MLX200

- Powerful high-speed six axis robot is ideal for multitude of applications.
- 12 kg wrist payload and additional mounting surface on upper arm (up to 10 kg), enables ease of integration of complex gripper tools without compromising performance.
- Enhanced robot work space features 1,440 mm horizontal reach and 2,511 mm vertical reach. The large work envelope extends behind the robot, allowing space for robot tool storage or maintenance.
- Hollow upper arm provides optimal cable protection while enhancing operational reliability. A 50 mm through-hole in the wrist encloses the cable and protects it from wear, interference or snagging.
- New, contoured arm design reduces interference with fixtures, parts or machinery.
- Patented double yoke upper arm design provides additional strength to protect the arm in case of undesired crashes.
- Symmetric wrist profile provides consistent motion and clearances regardless of robot approach.
- Floor-mounted model is standard. Wall- or ceiling-mounted versions are available. Brakes are included on all axes.
- The MH12 has an IP67-rated wrist and an IP54 body standard. An XP (eXtra Protection) package that increases the body protection rating to IP65 is available.
- An anti-corrosive paint option is available for environments where harsh acidic or alkaline cleaners are used, such as food processing facilities.
- Ideally suited for use in high-density work cells with multiple robots working in close proximity.

# MH12 ROBOT

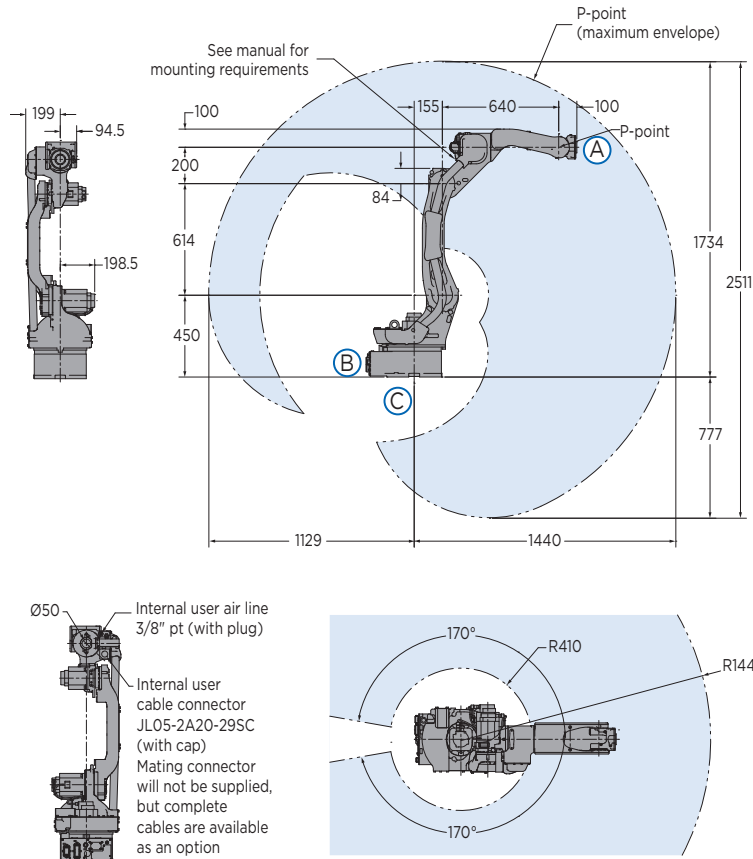

VIEW A

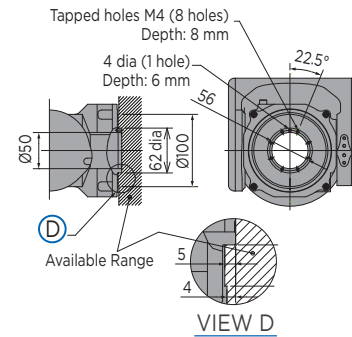

VIEW B

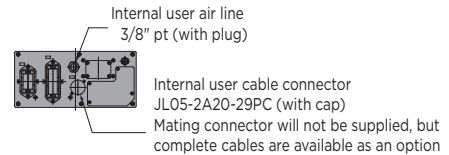

VIEW C

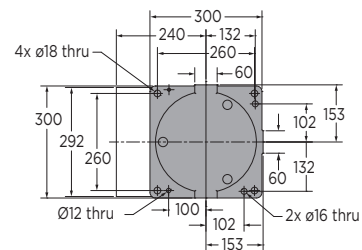

All dimensions are metric (mm) and for reference only.  
Request detailed drawings for all design/engineering requirements.

## SPECIFICATIONS

Axes	Maximum motion range [°]	Maximum speed [°/sec.]	Allowable moment [N•m]	Allowable moment of inertia [kg•m <sup>2</sup> ]	Controlled axes	
S	±170	220	-	-	Maximum payload [kg]	6
L	+155/-90	200	-	-	Repeatability [mm]	12
U	+240/-175	220	-	-	Horizontal reach [mm]	±0.08
R	±180	410	22	0.65	Vertical reach [mm]	1,440
B	±135	410	22	0.65	Weight [kg]	2,511
T	±360	610	9.8	0.17	Internal user I/O cable	130
					Internal user air line	17 conductors (+ ground)
					Power requirements	(1) 3/8" connection
					DX200	3-phase; 240/480/575 VAC at 50/60 Hz
					FS100	1- or 3-phase; 200/230 VAC at 50/60 Hz
					MLX200	3-phase; 200/230 VAC at 50/60 Hz
					Power rating [kVA]	
					DX200	1.5
					FS100	1.5
					MLX200	2.6

Specifications for MH12 with XP package may be different.

## OPTIONS

- Extended length manipulator cables
- Robot risers and base plates
- Wide variety of fieldbus cards
- MotoSight™ 2D and 3D vision systems
- Robot base and upper arm I/O cables
- XP package and anti-corrosive paint

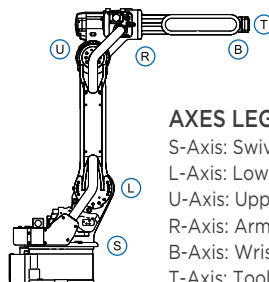

### AXES LEGEND

- S-Axis: Swivel Base
- L-Axis: Lower Arm
- U-Axis: Upper Arm
- R-Axis: Arm Roll
- B-Axis: Wrist Bend
- T-Axis: Tool Flange

Yaskawa America, Inc.  
Motoman Robotics Division

100 Automation Way  
Miamisburg, OH 45342  
Tel: 937.847.6200  
Fax: 937.847.6277

[motoman.com](http://motoman.com)

# YASKAWA