

MH215 II MH250 II

MACHINE TENDING | PART TRANSFER | PRESS TENDING

KEY BENEFITS

Optimized robot design with fast axial speeds and acceleration reduces cycle times and increases production output

Slim wrist profile for high density spacing and for reaching into confined spaces

Ideal for use in a wide variety of applications

SPECIFICATIONS

MH215 II:
215 kg payload
2,912 mm horizontal reach
3,894 mm vertical reach

MH250 II:
250 kg payload
2,710 mm horizontal reach
3,490 mm vertical reach

±0.2 mm repeatability

CONTROLLERS



DX200



FS100



MLX200

- Powerful six-axis handling robots feature high-rigidity speed reducers and high-speed motion which reduce cycle times.
- Payload capacity along with moment and inertia ratings allow these robots to easily handle large parts and heavy payloads.
- Streamlined upper arm design features a slim wrist profile. This allows easy reach into confined spaces, improving application flexibility.
- Robots can be mounted close to machines and fixtures, making best use of valuable floorspace.
- Large work envelope extends behind robot, allowing space for robot tool storage or maintenance.
- Ideal for “jigless” applications where robot positions part for processing by other robots or two robots handle a single part.
- Up to 70% less power consumption during motion and 25% savings during idle periods compared to previous models.
- Cables and air lines are routed through robot base to upper arm to increase cable life, enhance safety and reduce teaching time.
- Cable installation tube in the base of the robot facilitates fieldbus routing to the robot upper arm and/or gripper.
- Pre-wired for servo gripper which allows a wider range of product handling.
- An IP67-rated wrist and an IP54 body are standard with the MH215 II and MH250 II robots.

MH215 II | MH250 II ROBOTS

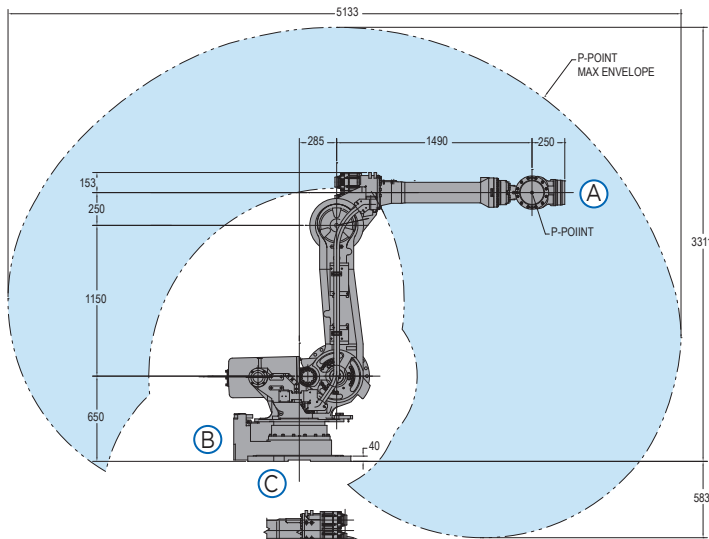

INTERNAL USER WIRING CONNECTOR (CASING SIDE)
TYPE JL05-2A24-28SC (WITH CAP) MATCHING
CONNECTOR IS NOT SUPPLIED BUT COMPLETE
CABLES ARE AVAILABLE AS AN OPTION

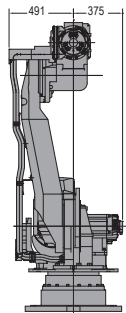

AIR (A & B) INLET PT 3/8
WITH PIPE PLUG

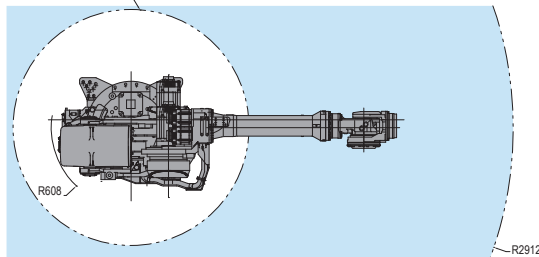

VIEW A

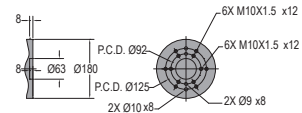

VIEW B

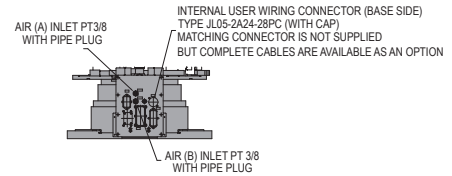

VIEW C

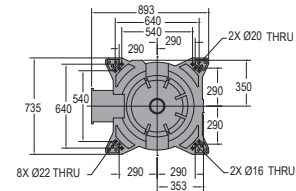

MH215 II is shown. All dimensions are metric (mm) and for reference only. Request detailed drawings for all design/engineering requirements.

SPECIFICATIONS: MH215 II | MH250 II

Axes	Maximum motion range [°]		Maximum speed [°/sec.]		Allowable moment [N•m]		Allowable moment of inertia [kg•m²]		Controlled axes	MH215 II	MH250 II
	MH215 II	MH250 II	MH215 II	MH250 II	MH215 II	MH250 II	MH215 II	MH250 II			
S	±180	±180	100	100	-	-	-	-	6	6	6
L	+76/-60	+76/-60	90	90	-	-	-	-	215	250	250
U	+230/-142.5	+230/-142.5	97	97	-	-	-	-	±0.2	±0.2	±0.2
R	±360	±360	120	120	1,176	1,386	317	317	2,912	2,710	2,710
B	±125	±125	120	120	1,176	1,386	317	317	3,894	3,490	3,490
T	±360	±360	190	190	710	735	200	200	0 to +45	0 to +45	0 to +45
									Humidity (non-condensing) [%]	20 - 80	20 - 80
									Weight [kg]	1,140	1,130
									Power supply, average [kVA]	5.0	6.0
									Internal I/O cable [conductors w/ ground]	24	24
									Internal air line [connections]	(2) 3/8"	(2) 3/8"

OPTIONS

- Extended length manipulator cables
- Robot risers and base plates
- External axis kits
- Wide variety of fieldbus cards
- Vision systems
- Robot base and upper arm I/O cables

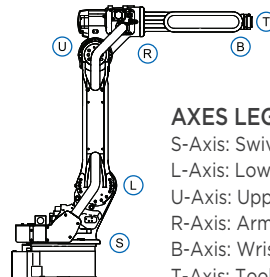

AXES LEGEND

- S-Axis: Swivel Base
- L-Axis: Lower Arm
- U-Axis: Upper Arm
- R-Axis: Arm Roll
- B-Axis: Wrist Bend
- T-Axis: Tool Flange

Yaskawa America, Inc.
Motoman Robotics Division

100 Automation Way
Miamisburg, OH 45342
Tel: 937.847.6200
Fax: 937.847.6277

motoman.com